

# LEO J. WELDER CENTER FOR THE PERFORMING ARTS

214 N. Main St. ▪ Victoria, Texas 77901  
www.weldercenter.com

## DR. CHARLES AND MARY KATHERINE BORCHERS PERFORMANCE HALL TECHNICAL INFORMATION SHEET

As of May 15, 2014

### GENERAL INFORMATION:

#### STAGE:

Proscenium Height-.....	18'
Proscenium Width-.....	41'6"
Batten Width-.....	51'6" (Lines 1-17)
.....	45'6" (Lines 18-20)
Grid Height-.....	49'
Stage Depth-.....	26'
Thrust Depth-.....	18'
Overall Stage Depth-.....	44'
Stage Height (from seating level)-.....	2'6"
Distance from Stage to First Row.....	8'

The loading dock has one loading bay and the door is 12'Wx10'H. The loading dock is ground level. The Pin-rail is 21'6" off Stage Right.

The Light/Sound Booth (Tech Booth) is located at the Back of the Hall on the 2<sup>nd</sup> level. The entrance to the booth is located House Left at the Back. Access is also available using the Elevator located at the south end of the lobby.

#### SEATING:

The maximum legal capacity of the Borchers Performance Hall is 482. There are 6 spaces dedicated for handicapped access. Public restrooms are located on the North and South side of the lobby.

#### DRESSING ROOMS/GREENROOM LOUNGE:

Dressing room capacity is 22. The dressing room/greenroom area is located stage right. The dressing area has wardrobe racks, makeup lights, and bathrooms. There are 2 private dressing rooms located in this area. See diagram included with this packet for layout details.

## **TECHNICAL INFORMATION:**

### **ELECTRICAL:**

Available disconnects:

1-400A 3-phase switch located Upstage Right

House switchboard is an ETC Express 48/96. The house system is dimmer-per-circuit. The house connector is 20A, 3-conductor stage pin connector. There are 166 circuits and they are distributed as follows:

Front of House Catwalk 1-33, Front of House Plug boxes (Right and Left) 34-45, Proscenium Catwalk 46-86, 1<sup>st</sup> Electrical (SR & SL) 87-97, 2<sup>nd</sup> Electrical (SR & SL) 98-108, 3<sup>rd</sup> Electrical (SR & SL) 109-114, Hanging plug boxes Downstage Right & Downstage Left 115-118, Hanging plug boxes Upstage Right & Upstage Left 119-122, Cyclorama (SR & SL) 123-134, Thrust Wall Stage Right 135-138, Thrust Wall Stage Left 139-142, , Upstage Right Back Wall 143-150, Upstage Left Back Wall 151-158 Downstage Right Proscenium 159-162, Downstage Left Proscenium 163-166

### **LIGHTING EQUIPMENT:**

#	TYPE	LAMP
12	ETC Source 4 Zoom (25°-50°)	575
8	ETC Source 4 26°	“
8	ETC Source 4 19°	“
18	ETC PAR	“
20	Altman 1K Fresnel	1000
6	Altman 4 unity Sky Cys	1000 per circuit
9	6” Fresnel	500
8	Altman ellipsoidal 6x9	740
6	Altman ellipsoidal 6x12	1000
4	Colortron scoops	1000
12	HID rehearsal lights	

There are 2 Ultra-Arc follow spots located in the Tech booth. There are 4 light tree's available.

### **SOUND EQUIPMENT:**

The sound system is stereo with the main speakers located stage left and right above thrust. The control cabinet is located in the sound and lighting booth at the back of the auditorium seating.

The Main console is a Soundcraft Series TWO with 40 input channels and eight sub mixers with stereo main and monitor outputs. There is a 24 band equalizer. The main amplifiers have left and right outputs of 400 amps each for use as main house sound. The

backstage monitor speakers are driven by a stereo amp of 600 watts each for left and right. There are 12 low-impedance microphone inputs and 2 monitor returns located on stage right and left of the Proscenium wall.

A list of available equipment is listed below:

Monitors.....	4
Handheld wireless microphones.....	4
Corded Microphones.....	8
Lapel Microphones.....	9
Direct Boxes.....	3
Microphone Stands.....	6

In addition to the main sound system a Default Sound System is installed. The control panel for the DSS is located Stage Right. The system includes a CD and Cassette player. There are 3 microphone inputs associated with the system. Two are located on the front of the stage and one is located Backstage Right.

### **AUDIO-VISUAL SYSTEM**

The AV system controls are located at stage right and at a CP3 touch screen control panel in the lighting booth. An electronically-operated 16' projection screen is located at center stage in front of the proscenium. Input panels are located at stage left and right, and in the control booth. The projector is a Vivitek D6010 with long zoom 2 lens. Four 55' monitors are located in the Rehearsal Hall (1), Green Room (1), Lobby (2).

### **PIANO**

The Welder Center has a nine foot Baldwin Grand piano stored in a climate controlled area. The piano may only be tuned by technicians approved by the Welder Center. Tuning Fees are billed to the Renter.

### **ASSISTIVE LISTENING DEVICE**

An Assistive Listening Device is installed in the Borchers Hall. The system is set on channel E. The Welder Center has 4 ALD units available to patrons.

### **INHOUSE COMMUNICATION SYSTEM**

The Communications System is a 1 channel Clear-Com system. There are 6 wired units and 2 wireless units available. The stations are distributed as follows:

4 inputs in Light/Sound Booth, 4 inputs in Catwalks, 1 input in Pin rail, 2 inputs in House, 2 inputs Backstage

### **FLY RIGGING:**

The installed Fly House is a double purchase, counter-weight system with 20 fly lines. A break-down of each line, its location and use follows. The electrics on stage have electrical powered hoists. Each is double batten with plug strips. **Any changes to fly schedule must be returned to the configuration below.**

LINE	DISTANCE	USE	NOTES
0	3'5"	Fire Curtain	
1	1'1"	Grand Valance	<b>May not be removed</b>
2	1'7"	Grand Drape	<b>May not be removed</b>
3	2'3"	1st Legs	RotoDraper pivot devices
4	3'7"	1st Electric	
5	5'7"	1st Border	
6	6'3"	2nd Legs	RotoDraper pivot devices
7	7'7"		
8	8'3"		
9	9'7"	2nd Electric	
10	10'7"	2nd Border	
11	12'3"	3rd Legs	RotoDraper pivot devices
12	13'7"		
13	14'3"		
14	15'7"	3rd Electric	
15	17'7"	3rd Border	
16	18'3"	4th Legs	RotoDraper pivot devices
17	19'7"		
18	20'3"		
19	20'11"	Black Traveler	<b>May not be removed</b>
20	21'7"	Cyclorama	

### **ACOUSTICAL CEILING**

Two lines of acoustical ceiling panels are permanently flown above the main stage. The panels include integrated lighting and may be lowered and manually configured from 0 degree to 90 degree angle relative to the stage floor.

### **HOUSE SOFT GOODS:**

- 1- Red Velvet Valance
- 1- Red Velvet Grand Drape
- 1- Black Velour Traveler Drape
- 4- Black Velour Borders
- 8- Black Velour Legs
- 1- White Leno Weaved Cyclorama

### **CONTACT:**

Leo J. Welder Center for the Performing Arts 361-485-8540, 361-582-2436  
weldercenter@victoriacollege.edu  
weldercenter.org

Theatre Victoria (Resident Company) 361-576-6277  
theatrevictoria.org

Box Office 361-570-8587

# LEO J. WELDER CENTER FOR THE PERFORMING ARTS

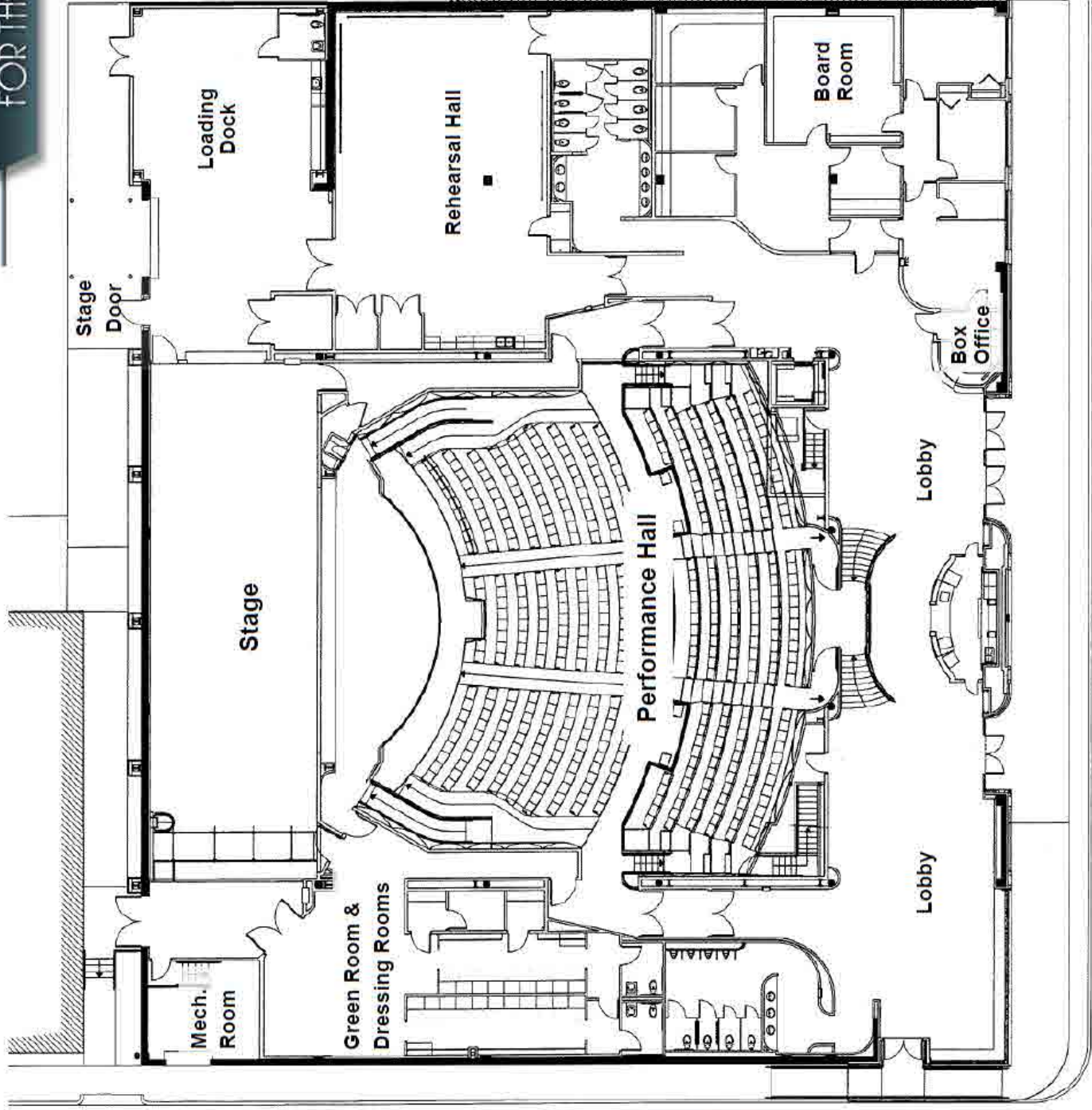

**Dr. Charles and Mary Katherine Borchers Performance Hall**  
476 seats

Proscenium : 41'6" wide x 18' height  
Stage: 26' deep; Thrust: 18' deep  
Light/Sound Booth is located at the back of hall on the mezzanine level.

**Lobby**

Amenities include concession bar, seating options and gallery space. Rented for social events, receptions and meetings.

**Rehearsal Hall**

Outfitted with full-length mirrors, black velvet drapes, kitchenette with refrigerator and sink. Available for rehearsals, VIP room, social events, seated dinners and meetings.

**Green Room/Dressing Rooms**

Dressing room capacity - 22; fitted with wardrobe racks, makeup lights, 2 restrooms  
2 VIP dressing rooms

**Loading Dock**

Door: 12'W x 10'H, ground level

**Charla Borchers Leon Board Room**  
Available for conference meetings and board meetings; capacity 14+

Goodwin St.

N. Main St.